

FLOOR 1

LOBBY

- 1 Penny Crusher
- 2 Gift Shop
- 3 Tickets/Information
- 4 Reptile Room
- 5 Coat Room
- 6 Baseball Diamond

NATURE TRAILS

- 7 Turtle Alley
- 8 Treehouse ***CLOSED**
- 9 River in Our Backyard
- 10 Beaver Lodge

*Our Treehouse exhibit has provided 23 years of climbing exploration for over one million visitors. In our commitment to ensuring a safe and enjoyable experience for all our visitors, this exhibit is temporarily closed for repairs. Our leadership team is working on securing funding, contractors, and supplies to complete the project as quickly and safely as possible.

NATURE TRAILS

Begin your adventure by learning about Maine's amazing animals, waterways, and mountains. Explore the Penobscot River Watershed as you send a boat from Mount Katahdin down to Penobscot Bay!

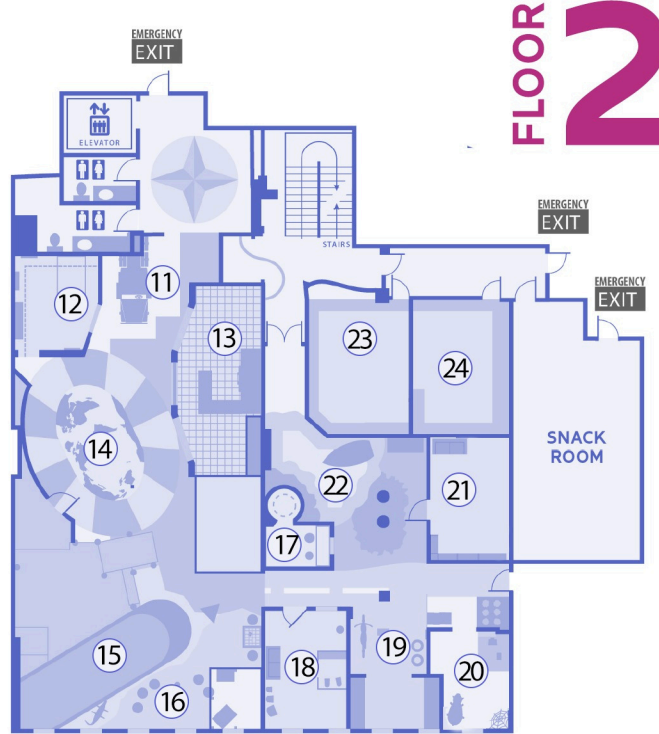

FLOOR 2

TRADEWINDS

- 11 Cole's Truck
- 12 Japan
- 13 Italian Bistro
- 14 World Map
- 15 Cargo Ship
- 16 Brazilian River House

BOOKTOWN

- 17 Puppet Theatre
- 18 Goodnight Moon
- 19 Condon's Garage
- 20 Zuckerman's Barn
- 21 Library
- 22 Tidely-Idely
- 23 Program Space
- 24 Robotics Factory

TRADEWINDS

All aboard! You're off to explore foreign ports of trade on our 30-foot cargo ship. After you're done loading cargo, check your compass, put the ship in gear, and steer your way to another part of the world.

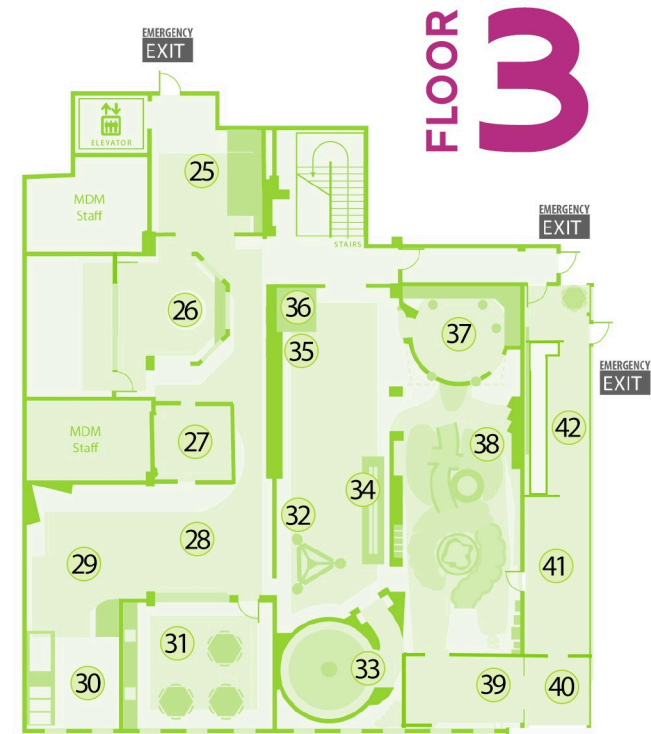

FLOOR 3

- 25 Fire Truck

ARTSCAPE

- 26 The Warming Sea
- 27 Glow
- 28 STEAMscape
- 29 You Build It
- 30 Toddler Area
- 31 STEAM lab

SUN, EARTH, UNIVERSE

- 32 Your Mission to Space, Build a Mars Habitat
- 33 The Engineering Cycle

SUN, EARTH, UNIVERSE

Blast off! In this hands-on exhibition, you'll learn about how scientists study the Earth, Sun, solar system and universe.

- 34 Gravity Tracks
- 35 Air Time
- 36 Invisible Science

BODY JOURNEY

- 37 Brain Games
- 38 Heart
- 39 Doctors Office
- 40 PetVet

DINO DIG

- 41 Toddler Exploration
- 42 Dino Dig Pit

Donate



Long-standing scientific research shows exploration and play are meaningful methods of learning. We know learning extends far

beyond the classroom.—it happens in our community, after school, and on weekends. Maine Discovery Museum's exhibits & programming, provide out-of-school learning opportunities that play a crucial role in reinforcing education for the whole family.

Maine Discovery Museum is a 501(c)(3), nonprofit, community-supported organization, your support will help us ensure that everyone in our community can access the educational and cultural resources unique to our Museum.

Programs of the MAINE DISCOVERY MUSEUM



Maine Discovery Museum (MDM) is critical in helping Mainers learn, especially in science, technology, engineering, and math (STEM). We have three floors of interactive exhibits and robust STEM programming within and outside the museum, and both paths introduce Mainers to the value and importance of discovery and exploration.

Membership

Purchasing a Maine Discovery Museum membership not only allows you to enjoy the Museum all year long with unlimited visits and exclusive benefits, it also provides funding to our programs and exhibits so the wonder of science and play is accessible to all.

HOUSEHOLD & FAMILY MEMBERSHIPS

Reciprocal Membership \$275

When you are a Reciprocal level member at MDM, you are eligible for benefits such as free general admission at 350+ ASTC venues & 50% off general admission at 200 participating ACM venues. Join the MDM Reciprocal family and start exploring today! Exclusions apply, and benefits vary.



Household Membership \$225

Two adults and all children 18 and under living in the same household.

You and Me Membership \$150

One adult and one child 18 and under living in the same household.

Guest Option Add-on

Add up to TWO guests to any membership for an additional \$50 per year.

Become a Member Today!



WE ALSO OFFER BUSINESS, NON-PROFIT & LIBRARY MEMBERSHIPS!



MARCH 19-23, 2025
mainesciencefestival.org

MAINE SCIENCE FESTIVAL

A program of
MAINE DISCOVERY MUSEUM

YEAR 10

MAINE DISCOVERY MUSEUM

MAP

Hours

Tuesday-Saturday 10AM-5PM

Sunday 12PM-5PM

My Day to Play

Sunday 10AM-12PM

Admission

\$14 Adults & Children

Free for Members

Get in Touch

74 Main Street, Bangor, ME 04401

PH (207) 262-7200

mainediscoverymuseum.org